

SSC2801-TM-2 Datasheet 01

Building an Efficient Fiber Infrastructure.

Overview

The SSC2801-TM-2 is used for data backhaul of enterprise network highway/railway cameras and APs. It supports deployment of straight-through, branching, and FastConnect optical cables, and is mainly used as a Hub Box in low-density access, chain deployment, branching, and cable distribution scenarios.

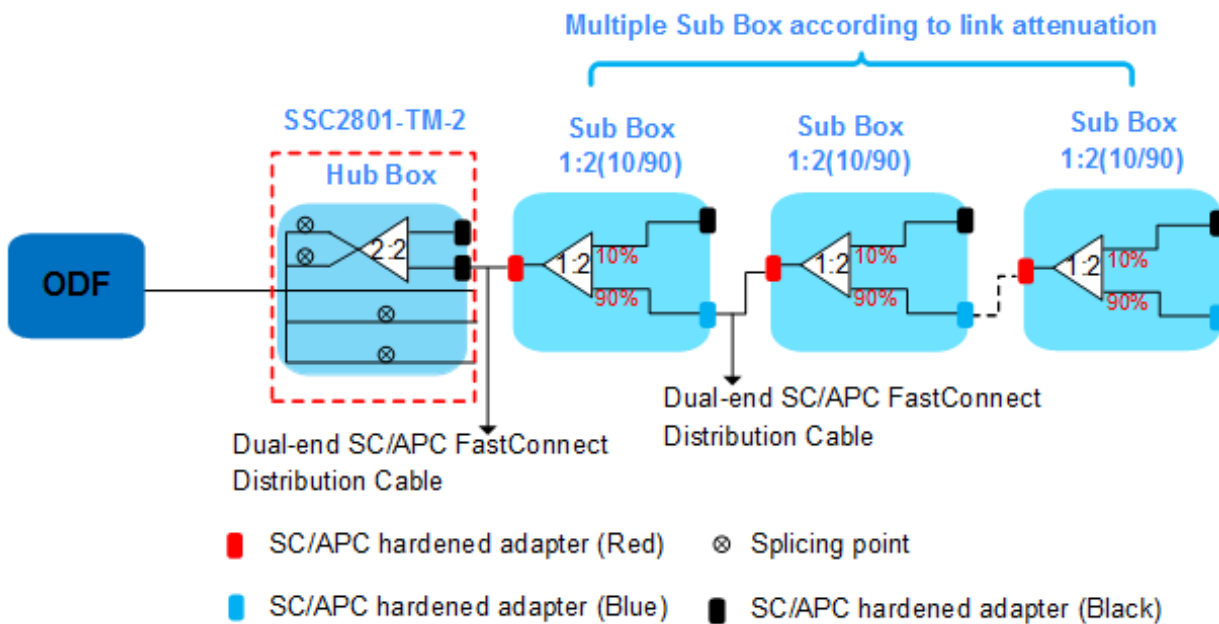

Features & Benefits

- Tool-free design, easily be opened and closed by the lever handle.
- Plug and play, FastConnect drop cable instead of splicing, and can be installed without opening the closure.
- FastPlug realizes cable fastening and sealing outside the closure, enabling fast installation.
- Supports dispatching fibers from same loose tube into different trays.
- Supports pole, wall, and aerial cable mounting.
- Supports overground, underground, manhole, and hand hole installation.
- Small size and elegant appearance.
- IP68 protection.

Structure

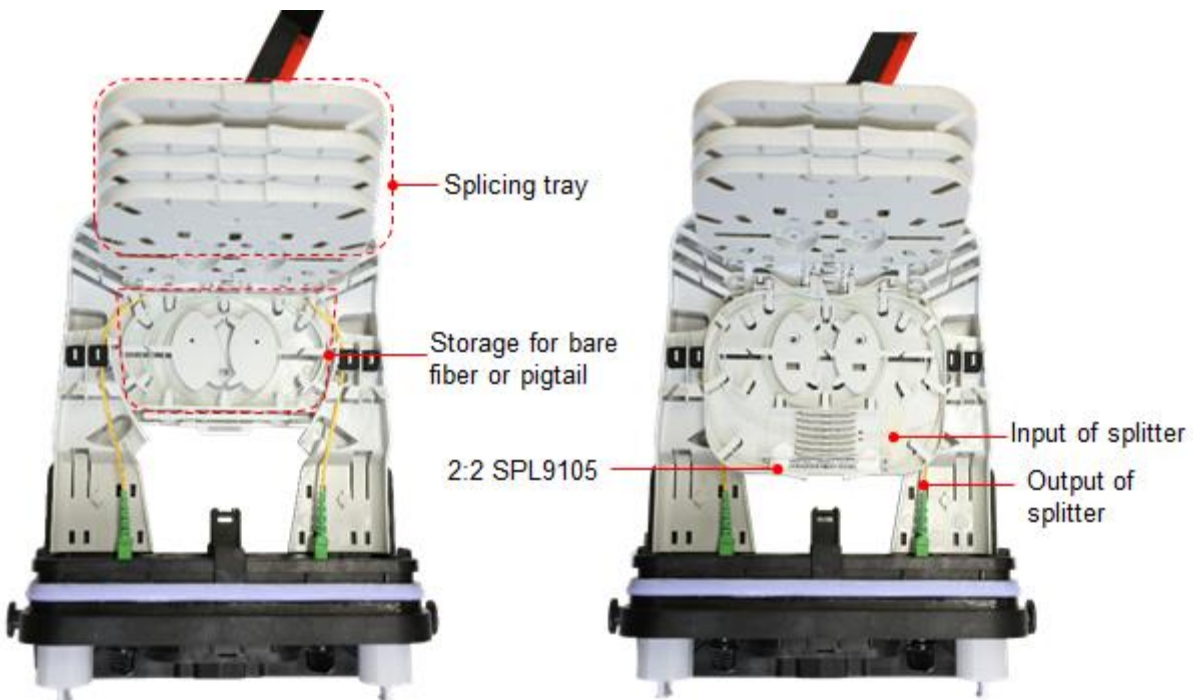
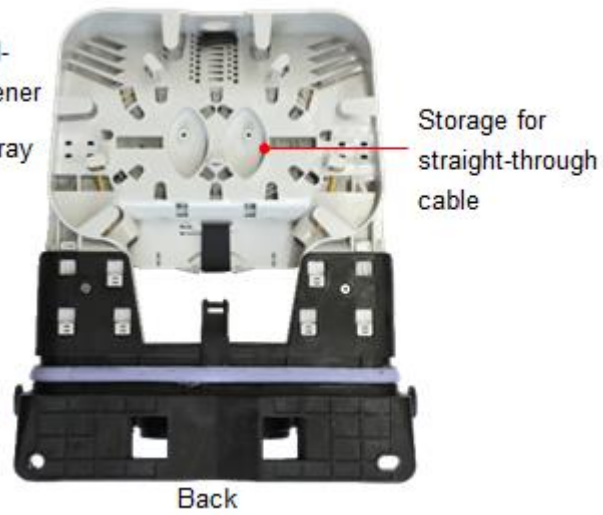
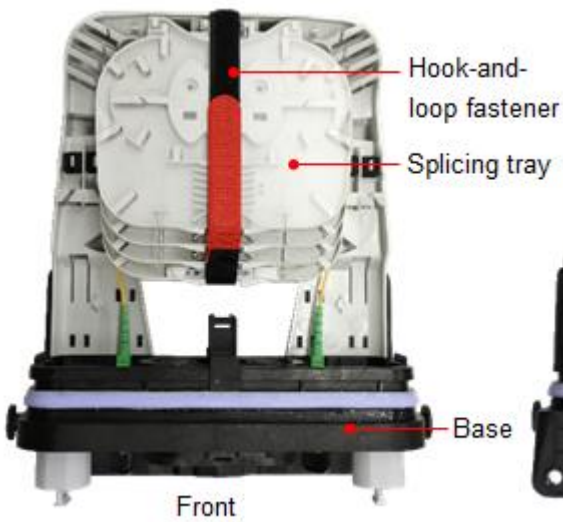
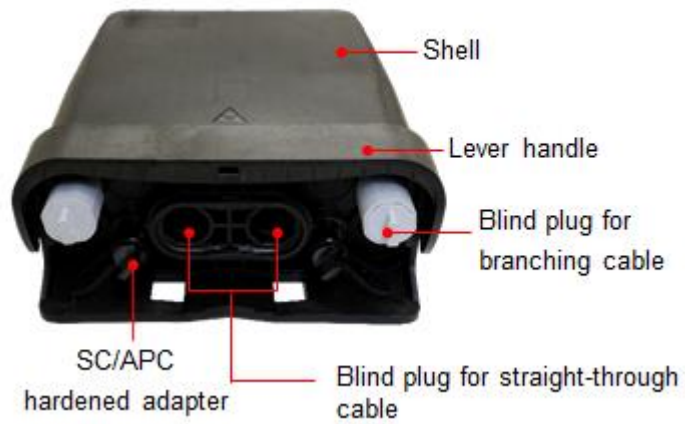

Specifications

Model	SSC2801-TM-2
Distribution capacity	2 cores (SC/APC hardened adapter)
Splicing capacity	48 cores
Splitter capacity	1 PCS 2:2 SPL9105
Type of splicing tray	FSM2107-12
Splicing capacity per tray	12 cores, 1 slot for SPL
Max. tray qty.	4
Optical cable inlets and outlets	1 PCS FP-S01 suitable for $\Phi 6$ mm to $\Phi 18$ mm straight-through cable 2 PCS FP-B01 suitable for $\Phi 5$ mm to $\Phi 12$ mm branching cable 2 PCS SC/APC hardened adapters
Installation mode	Pole, wall, aerial cable mounting
Application scenario	Overground, underground, manhole/hand hole installation
Dimensions (H x W x D; mm)	260 x 208 x 92 (without lever handle) 260 x 224 x 98 (with lever handle)
Package dimensions (H x W x D; mm)	355 x 237 x 126
Net weight (unit: kg)	1.5
Gross weight (unit: kg)	2.2
Materials	Plastic: Reinforced PP Metal: Stainless steel 304
Color	Black
Protection rating	IP68
Impact resistance	IK10
Flame-retardant rating	UL94-HB
RoHS and REACH	Compliant
Sealing mode	Mechanical
Adapter type	SC/APC hardened adapters

Environmental Parameters

Operating temperature	-40°C to +65°C
Storage temperature	-40°C to +70°C
Relative humidity	95% (+40°C)
Atmospheric pressure	70 kPa to 106 kPa

Schematic Diagram

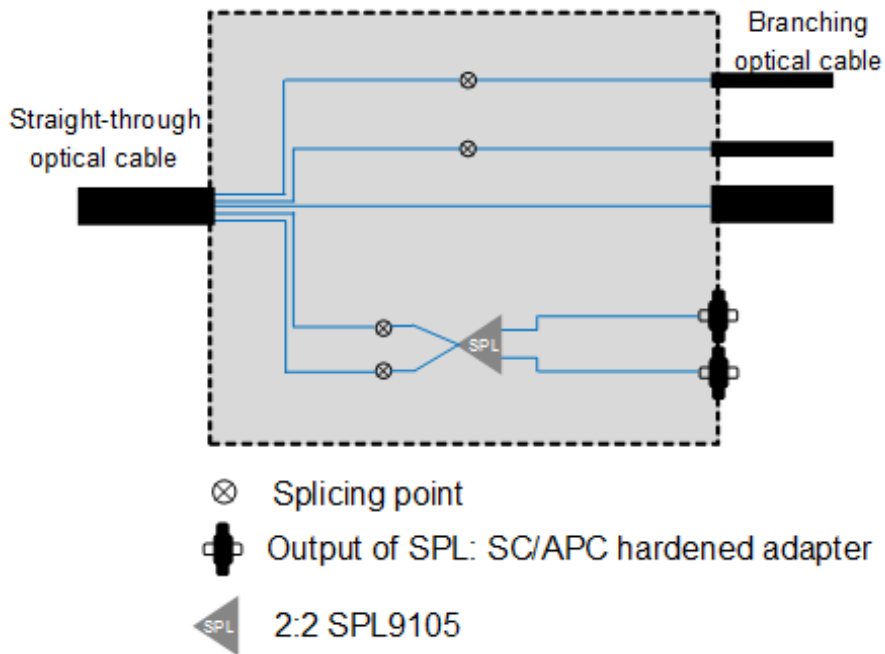

FastPlug Datasheet

Structure



FP-S01



FP-B01

Fast installation

Fast installation, fastening, and sealing of straight-through optical cable with the FastPlug.

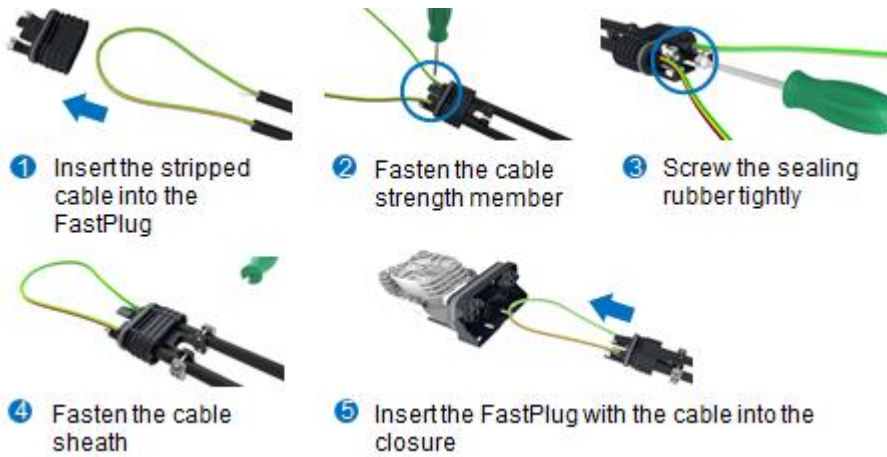

2:2 SPL9105 Datasheet

Overview

SPL9105 series bare optical splitters feature a compact size to implement the optical splitting function.

Features & Benefits

Product series:

- Connectors: SC/APC
- Splitting ratio: 2:2 50/50
- Standard pigtail length: 1.0 m

Flexible application:

- Low insertion loss and better uniformity

Structure



SPL9105 SC/APC 2:2 PLC

Specifications

Splitting ratio	Dimensions (H x W x D; unit: mm)	Fiber type	Pigtail length (m)	Pigtail diameter (mm)	Connector
2:2 50/50 PLC	4 x 7 x 60	G.657A1	Input: 1.0 ± 0.05 Output: 1.0 ± 0.05	0.9	Input: None Output: SC/APC

Performance Parameters

Splitting ratio	Operating bandwidth (nm)	Operating wavelength h (nm)	Insertion loss with connector (dB)	Return loss (dB)	Uniformity (dB)	PDL (dB)	Directivity (dB)
2:2 50/50 PLC	1260 to 1650	1310/1490/1550	≤ 4.2	≥55 (APC)	≤ 0.8	≤ 0.2	≥55

NOTE

1. The preceding results are from tests carried under the 1310/1550 nm wavelength and room temperature..
2. The preceding insertion loss includes the insertion loss of the connectors.
3. The end faces of connectors must be cleaned before the test.

Environmental Parameters

Storage temperature	-40°C to +85°C
Operating temperature	-40°C to +85°C
Relative humidity	≤ 95%
Atmospheric pressure	70 kPa to 106 kPa

Splicing Tray Datasheet

Structure



FSM2107-12

Specifications

Item	FSM2107-12
Splicing capacity per tray (unit: core)	12
Splitter capacity	1 PCS 2:2 SPL9105
Dimensions (H x W x D; unit: mm)	134 x 115 x 8
Net weight (unit: g)	26
Material	PC+ABS
Color	Cool Gray 3C

Copyright © Huawei Technologies Co., Ltd. 2020. All rights reserved.

No part of this document may be reproduced or transmitted in any form or by any means without prior written consent of Huawei Technologies Co., Ltd.

Trademarks and Permissions

 HUAWEI and other Huawei trademarks are trademarks of Huawei Technologies Co., Ltd.

All other trademarks and trade names mentioned in this document are the property of their respective holders.

Notice

The purchased products, services and features are stipulated by the contract made between Huawei and the customer. All or part of the products, services and features described in this document may not be within the purchase scope or the usage scope. Unless otherwise specified in the contract, all statements, information, and recommendations in this document are provided "AS IS" without warranties, guarantees or representations of any kind, either express or implied.

The information in this document is subject to change without notice. Every effort has been made in the preparation of this document to ensure accuracy of the contents, but all statements, information, and recommendations in this document do not constitute a warranty of any kind, express or implied.

Huawei Technologies Co., Ltd.

Address: Huawei Industrial Base Bantian,
Longgang Shenzhen 518129 People's
Republic of China

Website: www.huawei.com