

Prefabricated Data Center

FusionModule1000A Prefabricated All-in-One Data Center

Introduction

Huawei FusionModule1000A is an advanced outdoor and prefabricated all-in-one data center facility solution. The solution provides reliable, stable and green environment for IT equipment. The solution can be applied to multiple industries and scenarios and meet data center's requirements on energy saving and fast deployment.

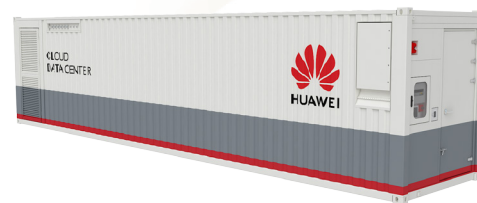

FusionModule1000A 40ft

Applicable Industry and Scenario

Enterprise: small data center

Government: data center of smart city and safe city

Education: data center of university and science institute

Energy: data center of mining and exploration field

Finance: backup data center

Transportation: power supply room of airport/railway station/port

Telecom carrier: small IDC, DR DC, edge DC

Features & Value

Simple

- Enclosure, power, cooling, firefighting DCIM system, server and switch are prefabricated. All facilities are preinstalled and tested before delivery
- Productized solution minimizes the engineering work and the on-site installation of a plug& play data center only takes one day.
- Moveable design makes relocation easy and deployment flexibly.

Efficient

- High-efficiency modular UPS, smart in-row cooling, aisle containment, enclosure of low heat transfer coefficient, industry-leading PUE
- Huawei NetEco system centralizes the management of multiple sites.
- Efficient O&M anywhere& anytime with PAD and mobile APP

Reliable

- Durable enclosure with 25-year service life
- IP55 protection (IP65 optional) and GR-63-CORE Zone3 anti-seismic 120min fire-resistance when covered with customized fire-proof panel, EN 1627-EN 1630 Class 3 anti-theft(optional)

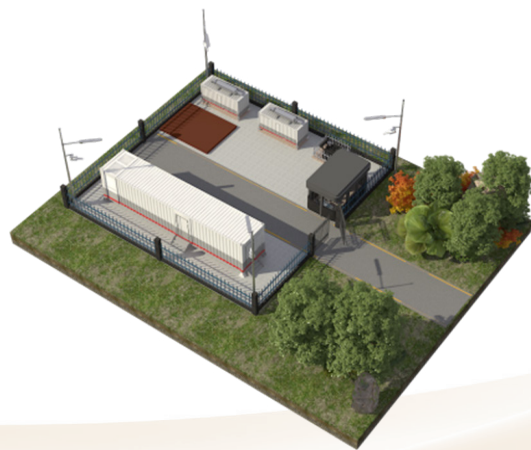

FusionModule1000A Site

Layout

FusionModule1000A-40ft-IT-2N

Layout

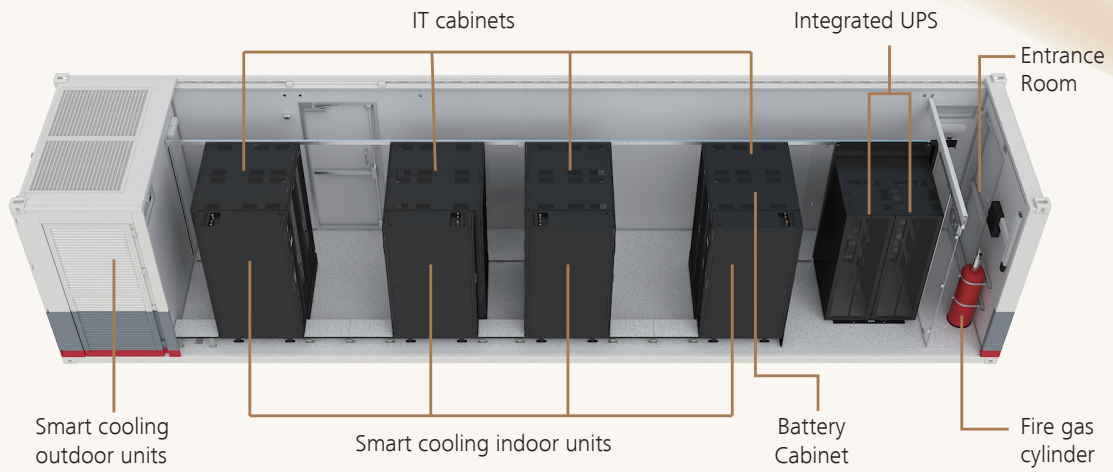

Plan View

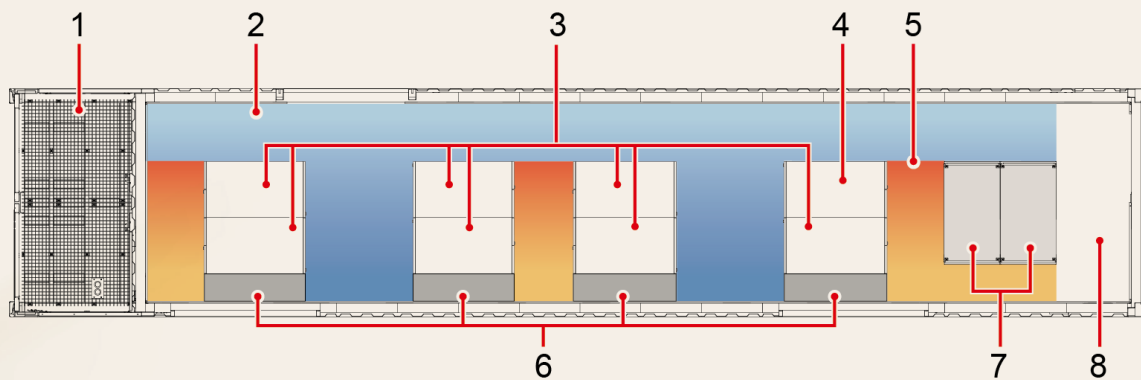

- ① Cooling units
- ② Cold aisle
- ③ IT cabinet
- ④ Battery cabinet
- ⑤ Hot aisle
- ⑥ Cooling units
- ⑦ Integrated UPS
- ⑧ Entrance room

Management System

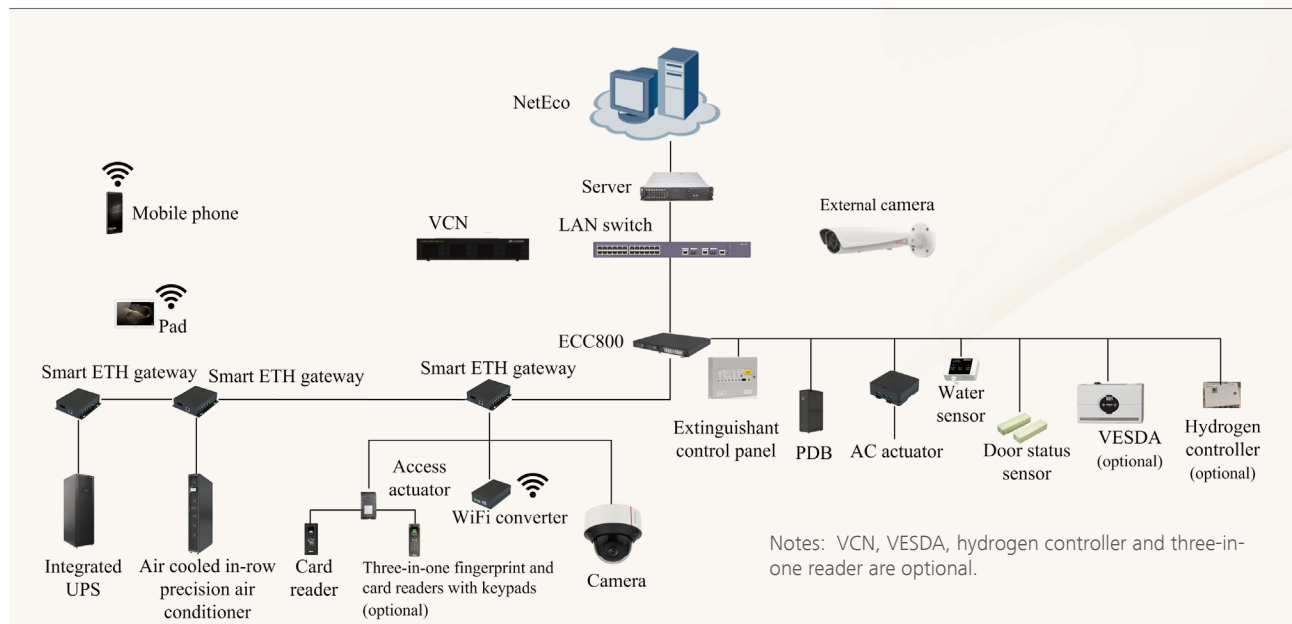

Local Display

The local display interface features a 'Home' screen with a green header. It includes a search icon for 'Open Door' and a settings gear. The main content area shows a 3D server rack with a temperature gradient from 18°C to 35°C. Below the rack, there are four summary cards: 'Resource' (Power: 18.4%, Cooling: 88.0%, Space: 65.1%), 'Energy' (PUe=2.69), 'Environment' (50.0°C, 20%RH), and 'Alarm' (0 Critical, 10 Major, 1 Minor, 0 Warning). Navigation icons for Home, iPower, iCooling, and More are on the left.

Mobile Phone APP

The mobile phone application provides detailed monitoring across five screens:

- Homepage:** Overview of Power, Energy, Environment, and Resource metrics.
- Real-time Alarm:** Lists active and historical alarms, such as 'Mains undervoltage 3' and 'Main temperature abnormal 1'.
- Power:** Displays PUE (2.69) and a bar chart of Power, IT Power, and Smart Cooling Power.
- Cooling:** Shows air conditioner information for 'NetCol1', including compressor speed (0 RPM), fan outputs (22%), and cooling capacity (18.0 kW).
- Resource:** Features a circular gauge for 'Load Ratio' at 42.4% and a bar chart of current power for IT Cabinet 1, IT Cabinet 2, and IT Cabinet 3.

Specifications

System	Sub-item	FusionModule1000A 40ft-IT-2N-208V ^②	System	Sub-item	FusionModule1000A 40ft-IT-2N-208V ^②
Power	Total IT load	≤ 42kW	Monitoring	Module access	IC card reader as default optional three-in-one access control
	Power density per rack	≤ 6kW		Rack access	Customization ^①
	Input mode	3Ph+N+PE, 208V /220V /230V AC, 60Hz		Monitoring management	Real-time monitoring of temperature and humidity control, fire control, access control and cooling system
	UPS model	Integrated modular UPS(with integrated MCCB)		In-module display	PAD
	UPS capacity	60kVA		Remote O&M	App
	Number of UPS power module	3		Management	DCIM
	BAT backup time	10min	Server		Pre-installed
	Basic rPDU	Standard	Lan switch		Pre-installed
	Surge protection	Level-2, maximum 60kA 8/20us	Enclosure	External size (H × W × D)mm	2896 × 2438 × 12192
Rack	Rack capacity	7 × 42U IT rack		Aisle width	cold aisle of 1150mm; hot aisle can be extended to 610mm;
	Rack distribution	7 × 6kW/rack		Protection	Dustproof and waterproof
	Size (H × W × D) mm	600 × 1100 × 2000 600 × 1200 × 2000	Anti-seismic		GR-63-CORE Zone3
Cooling	Technology	Air-cooled in-row	Anti-theft	Meet requirements of EN 1627-EN 1630 Class 3	
	Sensible cooling capacity	21kW/unit(3+1 redundancy)	Operating Environment	Operating humidity (RH)	5%~95%
	Coolant	R410A		Operating temp	-20°C~+45°C
	Fan type	EC fan		Altitude ^③	≤ 4000m
	Compressor	DC variable-frequency	Fire protection	Auto fire protection system	Automatic fire detection & suppression system c/w emergency release function
	Group control	Support		Alarm	Automatic monitoring and detection, support sound and light alarm
	Temp. range	18~27°C		Gas	Standard HFC-227ea
	Humidity range	20%~80%			
	Hot/cold aisle	Hot aisle containment			
Humidification	Electrode humidifier				

① : Customized access control will cause changes to U space and monitoring solution.

② : 2N refers to redundancy level of power system.

③ : Power derating is required when the altitude is over 1000m.Details refer to the Product Overview

Copyright © Huawei Technologies Co., Ltd. 2018. All rights reserved.

No part of this document may be reproduced or transmitted in any form or by any means without prior written consent of Huawei Technologies Co., Ltd.

General Disclaimer

The information in this document may contain predictive statements including, without limitation, statements regarding the future financial and operating results, future product portfolio, new technology, etc. There are a number of factors that could cause actual results and developments to differ materially from those expressed or implied in the predictive statements. Therefore, such information is provided for reference purpose only and constitutes neither an offer nor an acceptance. Huawei may change the information at any time without notice.

HUAWEI TECHNOLOGIES CO., LTD.

Huawei Industrial Base
Bantian Longgang
Shenzhen 518129, P.R. China
Tel: +86-755-28780808

www.huawei.com